

Layout Dimension & Working Range

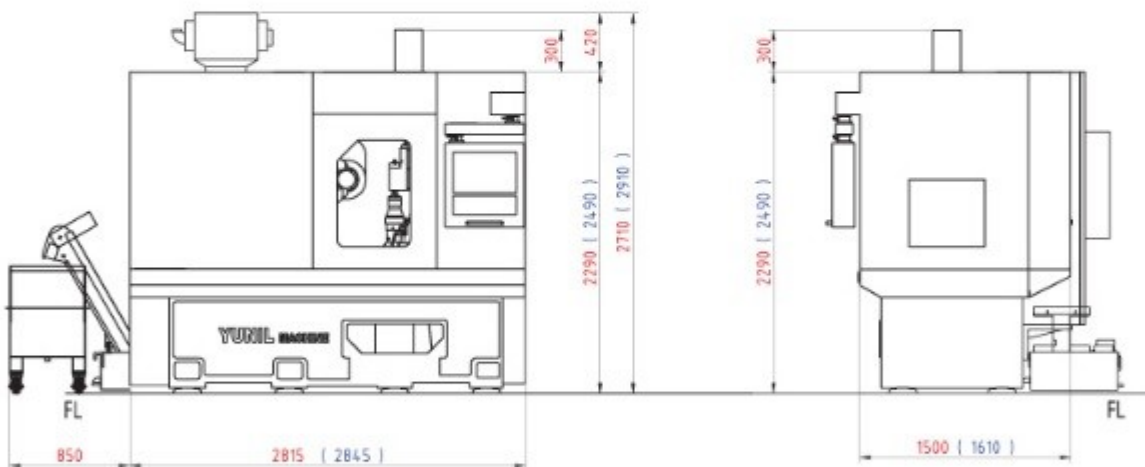
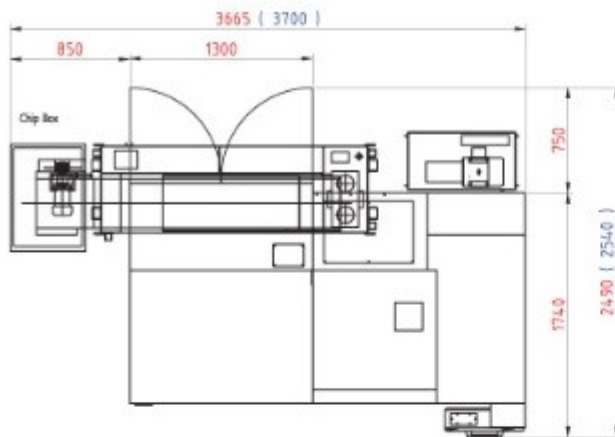

Working Range	HERA 200s	HERA 350s
X-AXIS STROKE	ST250 : 10~260	ST280 : 30~310
Y-AXIS STROKE	ST160 : 0~160	ST180 : 0~180
Z-AXIS STROKE	ST250 : 150~400	ST320 : 150~470
CENTER STROKE	ST260 : 340~640	ST320 : 340~690