

CNC ROTARY TABLE

TRM



CNC Manual Tilting Rotary Table

- ◆ High accuracy and worm wheel provides long term duration.
- ◆ High rigidity and allows heavy loads.
- ◆ Can be operated by single axis controller.
- ◆ Tilting axis is manual and rotating axis is controlled by CNC.

Model No. : TRM-322



TILTING ROTARY TABLE

Item/Model No.		TRM-202	TRM-252	TRM-322			
Diameter of Table	mm/inch	φ 200/7.87	φ 250/9.84	φ 320/12.60			
Diameter of Thru-hole	mm/inch	φ 35/1.38	φ 70/2.76	φ 110/4.33			
Overall Height in Horizontal	mm/inch	279/10.98	343/13.50	330/12.99			
Center Height in Vertical	mm/inch	190/7.48	240/9.45	270/10.63			
Overall Height in Vertical	mm/inch	427/16.81	600/23.62	590/23.23			
Width of T Slot	mm	12 ^{H7}	12 ^{H7}	14 ^{H7}			
Clamping Torque	(Pneumatic:6kg/cm ²)	25	47	71			
	(Hydraulic:20kg/cm ²)	50	94	142			
Servo Motor Type	Rotating Axis	Tilting Axis	Rotating Axis	Tilting Axis	Rotating Axis	Tilting Axis	
	FANUC	α 4i	Manual	α 8i	Manual	α 12i	Manual
	MITSUBISHI	HF-103	Manual	HF-153	Manual	HF-203	Manual
	SIEMENS	1FK7060	Manual	1FK7063	Manual	1FK7083	Manual
	HEIDENHAIN	QSY116C	Manual	QSY116J	Manual	QSY155B	Manual
Total Reduction Ratio	deg.	1:90	1:90	1:90			
MAX. Rotation Speed(Motor:2000RPM)	rpm	22.2	22.2	22.2			
Tilting Degree	deg.	0-100°	0-100°	0-100°			
Indexing Accuracy	sec.	25°	15°	15°			
Repeatability Accuracy	Unidirectional	deg.	8°	4°	4°		
	Bidirectional	deg.	16°	8°	8°		
MAX. Work Load	Vertical	kg	100	125	150		
	Horizontal	kg	200	300	350		
MAX. Thrust Load	F	kgf · m	600	1208	1375		
	FxL	kgf · m	16	18	26		
MAX. Thrust Load	FxL	kgf · in	20	72	92		
	N.W.	kg	90	200	310		

- ◆ Standard accessories : eye bolts, fixture blocks
- ◆ Suitable tailstocks refer to p.52
- ◆ Suitable controllers refer to p.56

TRM-202

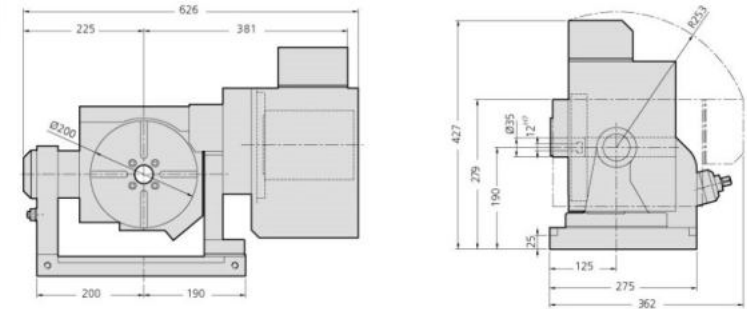

TRM-252

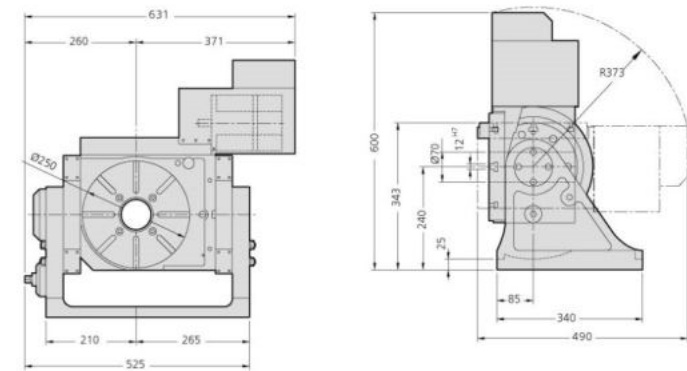

TRM-322

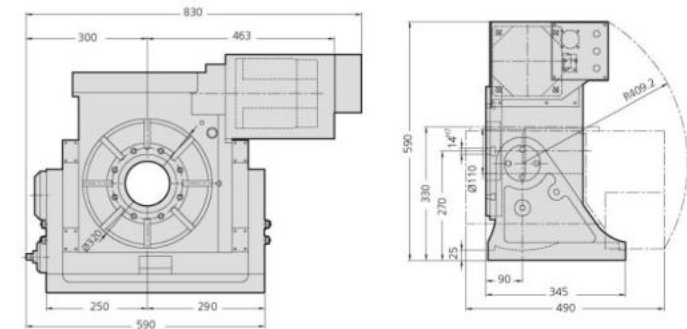

★ The size of motor metal sheet will change in accordance with real use of brand and model.

Item/Model No.		TRM-402	TRM-502	TRM-632
Diameter of Table	mm/inch	φ 400/15.75	φ 500/19.69	φ 630/24.80
Diameter of Thru-hole	mm/inch	φ 150/5.91	φ 180/7.09	φ 254/10.00
Overall Height in Horizontal	mm/inch	375/14.76	400/15.75	480/18.90
Center Height in Vertical	mm/inch	290/11.42	330/12.99	440/17.32
Overall Height in Vertical	mm/inch	625/24.61	745/29.33	940/37.01
Width of T Slot	mm	14 ^{H7}	18 ^{H7}	18 ^{H7}
Clamping Torque	(Pneumatic:6kg/cm ²)	92	125	350
	(Hydraulic:20kg/cm ²)	184	250	700
Servo Motor Type	Rotating Axis	Tilting Axis	Rotating Axis	Tilting Axis
	FANUC	α 12i	α 22i	α 22i
	mitsubishi	HF-203	HF-353	HF-353
	SIEMENS	1FK7083	1FK7101	1FK7101
	HEIDENHAIN	QSY155B	QSY155D	QSY155D
Total Reduction Ratio	deg.	1:90	1:180	1:180
MAX. Rotation Speed(Motor:2000RPM)	RPM	22.2	11.11	11.11
Tilting Degree	deg.	0-100°	0-100°	0-100°
Indexing Accuracy	sec.	15"	15"	15"
Repeatability Accuracy	Unidirectional	deg.	4"	4"
	Bidirectional	deg.	8"	8"
MAX. Work Load	Vertical	kg	300	350
	Horizontal	kg	500	600
MAX. Thrust Load	F	kgf · m	1585	1880
	FxL	kgf · m	36	89
N.W.	FxL	kgf · m	122	165
		kg	380	600

- ◆ Standard accessories : eye bolts, fixture blocks
- ◆ Suitable tailstocks refer to p.52
- ◆ Suitable controllers refer to p.56

TRM-402

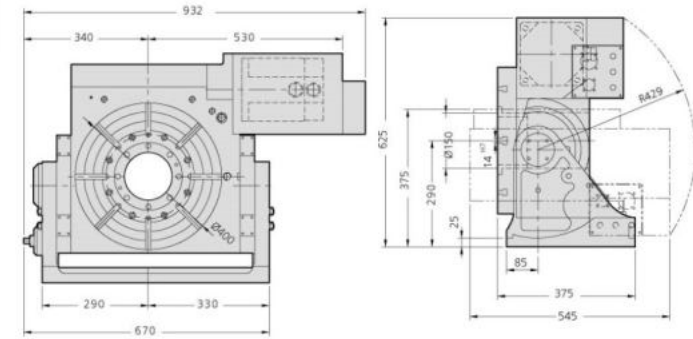

TRM-502

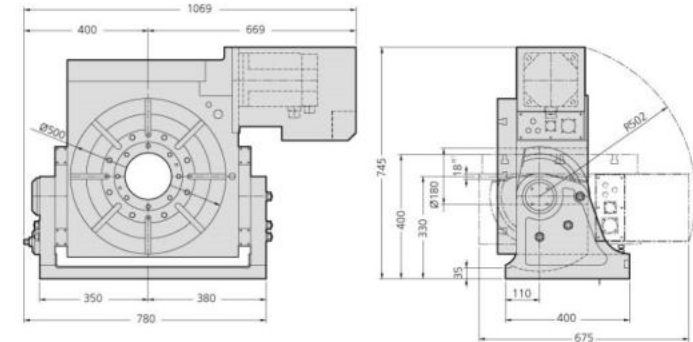

TRM-632

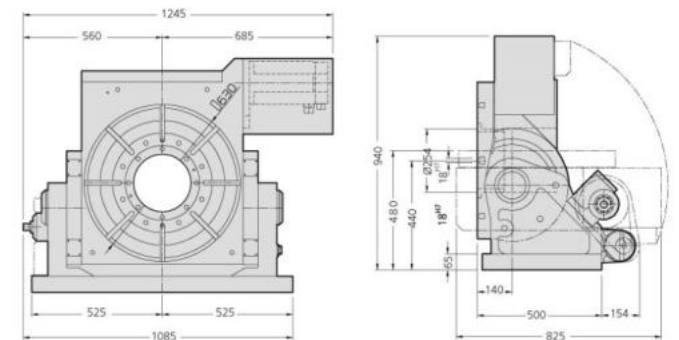

★ The size of motor metal sheet will change in accordance with real use of brand and model.